

RECEIVED AND PROCESSED
BY LAND DEVELOPMENT
INITIALS
MAR 08 2017

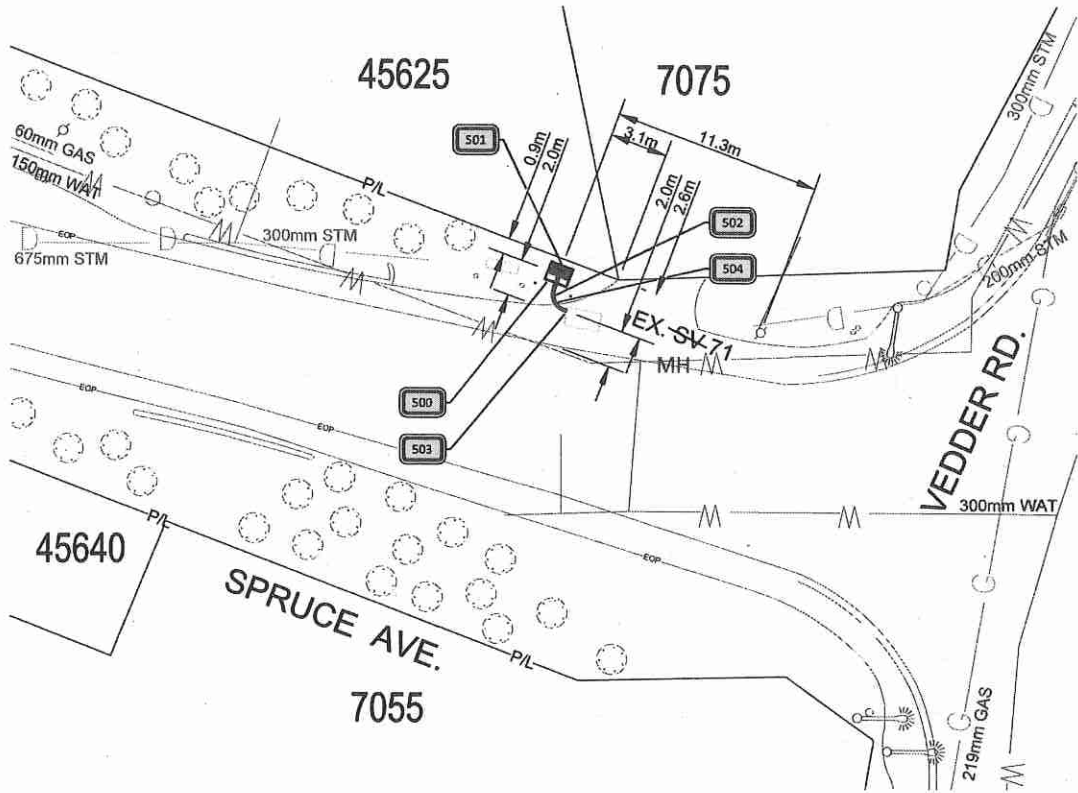

PLAN VIEW
HORIZONTAL SCALE: 1 : 250

NOTES:

500	INSTALL 854F FDH ON CONCRETE PAD WITH 2x BOLLARDS. SEE DETAIL 'C' SHEET 500
501	STUB 2-100mm DUCTS 0.6m ABOVE FINISHED GRADE
502	INSTALL (2) 100mm DBII PVC CONDUIT L= 4.0 m. SEE DETAIL 'B' SHEET 500
503	CORE FOR 2-100mm CONDUIT IN TELUS SV 71 SEE DETAIL 'A' SHEET 500
504	NEW 80° BEND 2-100mm DBII PVC CONDUIT

Sheet Title:
Design
Function: Make ready Task: FDH Placement

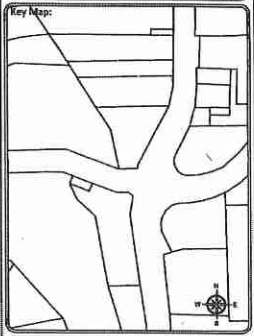

DO ONE CALL
CALL BEFORE YOU DIG
1-800-495-5859
OR BY ONLINE TOOL
WWW.ONECALL.CA
CALL AT LEAST TWO FULL BUSINESS DAYS
BEFORE YOU PLAN TO DIG

Client: TELUS

Prepared By: FAFL
SUITE 200 - 7485 130 ST
Surrey BC V3W 3H8

Rev	Date	Notes	QC
-	-	-	-
-	-	-	-
-	-	IFC: MARCH 9TH 2017	-
-	-	IFP: March 3 2017	-
DRAWN BY:		SHIDRI YAGISHITA	
DESIGNED BY:		KADTEC SYSTEMS	

Proprietary Information
Not for disclosure except under written agreement

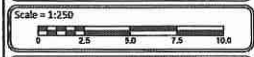

Project: Falcon 2017
SRDS 1021A - 262659
Sardis, BC

File Name:
COID: SRDS Route: 1021A
Network Number: 262659 Sheet Number: 600

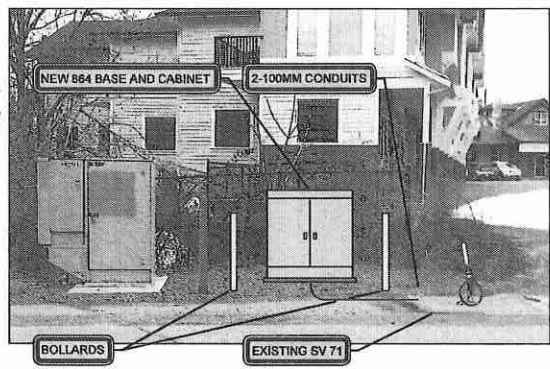

45625 SPRUCE DR
FDH - SITE PLAN
N.T.S.

CAUTION:
GAS FACILITIES IN AREA
LOCATE AND EXPOSE
PRIOR TO COMMENCING WORK

METHOD OF PLACEMENT
VIA OPEN TRENCH UNLESS
OTHERWISE NOTED

LOCATE AND PROTECT ALL
OTHER UTILITIES IN FIELD

ALL MEASUREMENTS ARE IN
METERS UNLESS NOTED

Date: May 16, 2017 Author: Kat McCawley 604-444-3732 ext 247, 604-366-8857 Project: SRDS 1021A - 2626659
 Universal Flagging: 170-8061 Lougheed Hwy, Burnaby, BC V5A 1W9 Office: 604-444-3732 Dwg: 001

Comments:

AFL Global/ Telus
 Kelly Buchanan: 250-485-7330
 City of Chilliwack
 Job location: Spruce and Vedder
 Closure description: SLAT
 Tentative date and hours: May 29- June 7, 2017
 Job description: Civil Construction- New Conduit and pad construction for Fibre Distribution Hub Cabinet



Advanced Warning Sign distances may be shortened due to Urban block length

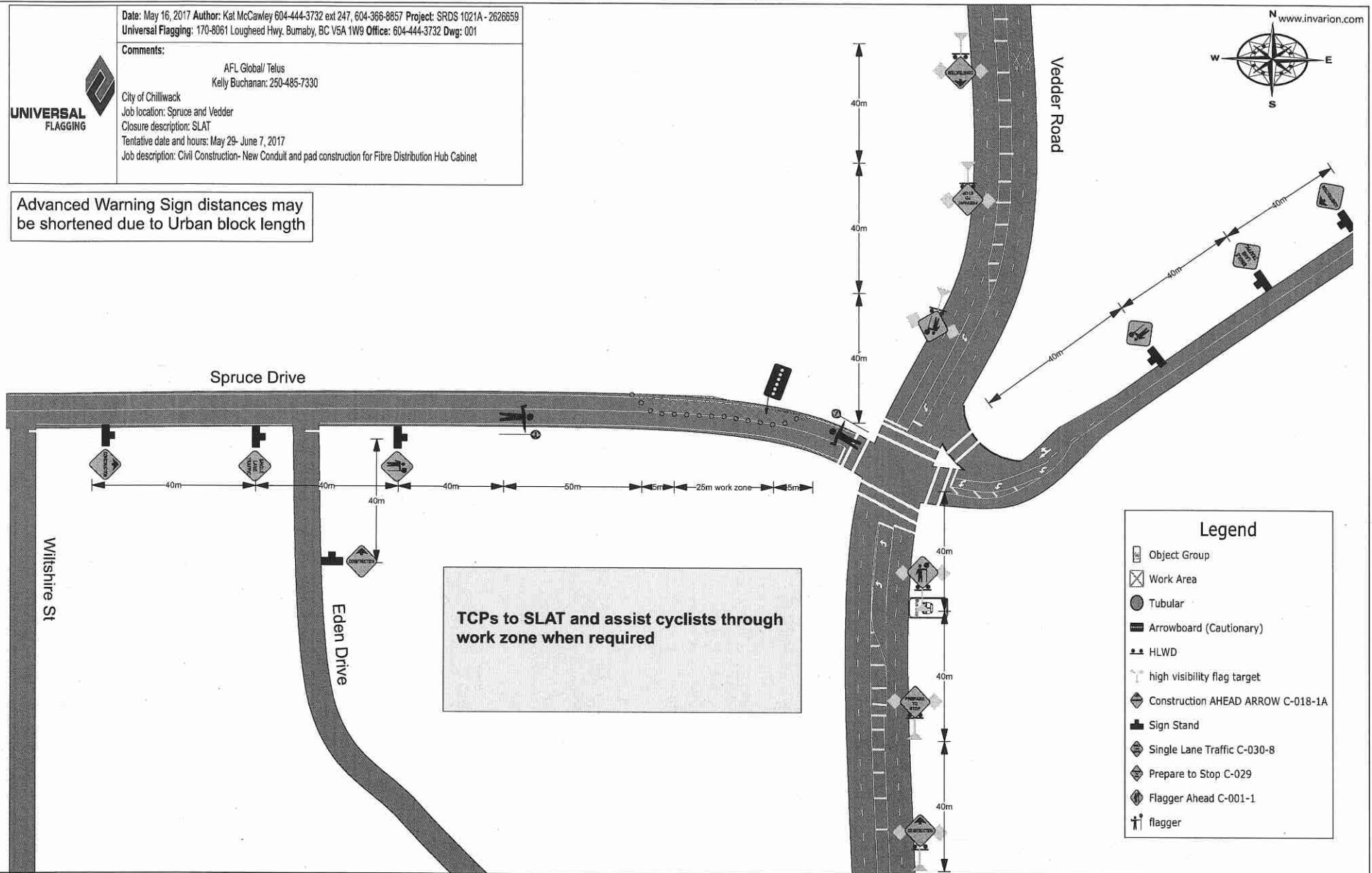

Legend	
	Object Group
	Work Area
	Tubular
	Arrowboard (Cautionary)
	HLWD
	high visibility flag target
	Construction AHEAD ARROW C-018-1A
	Sign Stand
	Single Lane Traffic C-030-8
	Prepare to Stop C-029
	Flagger Ahead C-001-1
	flagger